

# Thermotech's product range for large premises

Thermotech group manifolds and big mixing units are, as well as the rest of our product range, completely mounted when delivered. They have a clean design in stainless steel and they are easy to install.

Together with our feed pipes you will get a system solution with many advantages:

- Use 25 x 2,3 mm or 32 x 3 mm feed pipes and you can avoid large, unwieldy pipes. The dimension of the feed pipes can be kept smaller
- The pressure drop in the entire system will be lower
- Adjustment of all flow levels can easily be done in one place
- Parallel mounted system of this kind is considerably easier to balance
- All manifolds are connected seamlessly against bigger manifolds
- A good system operation is ensured
- This kind of solution is economic, both to purchase and to operate

You will get a custom-made system solution, from feedpipes to manifold and controlling.

Read more on our web site, [www.thermotech.eu](http://www.thermotech.eu)

# Thermotech underfloor heating

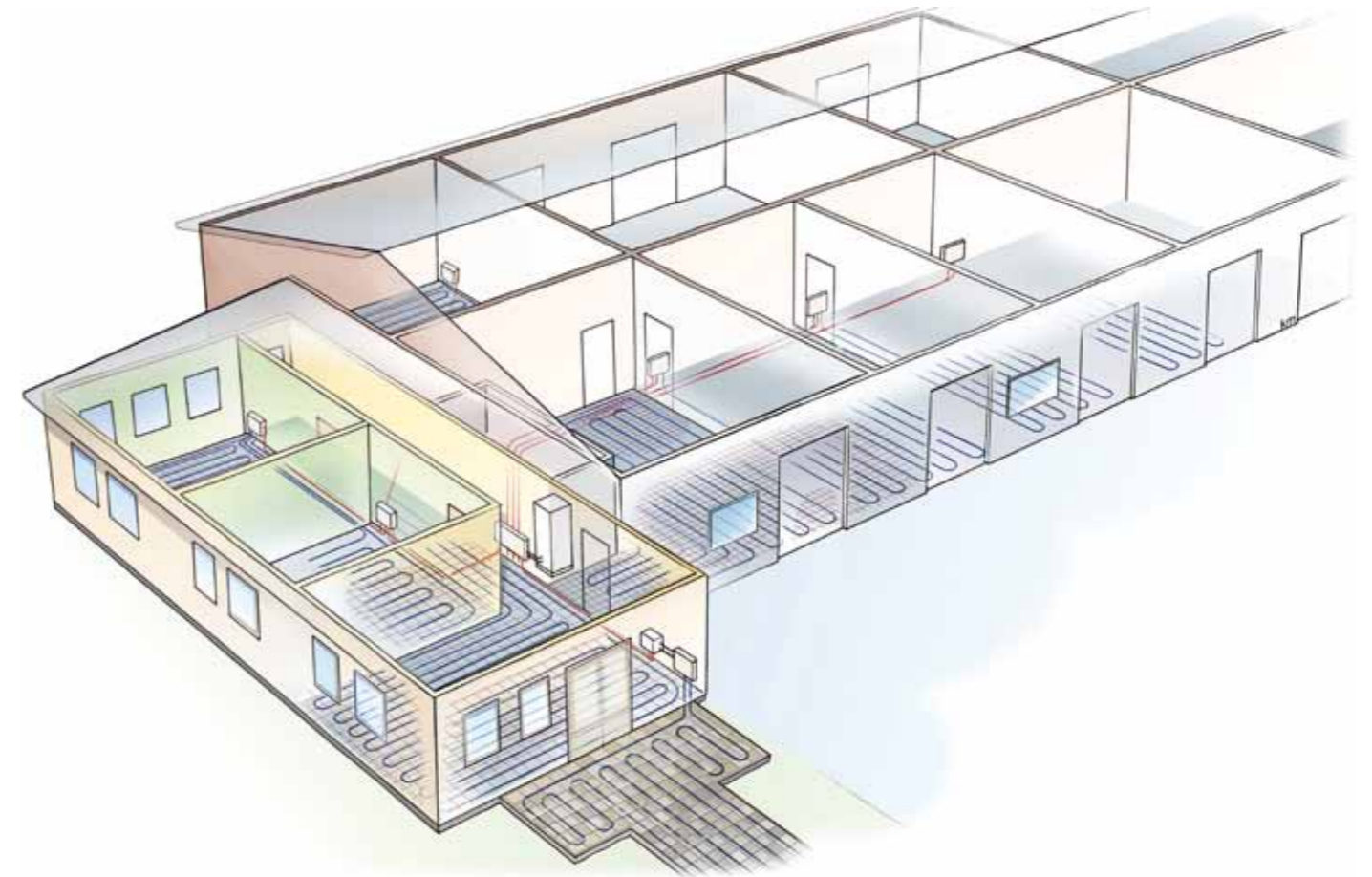

System solutions  
for large premises



# An overview - system solutions for large premises

